

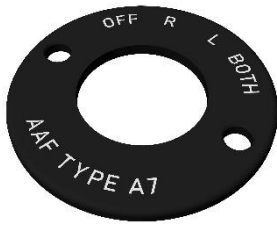

Components provided:



Front Dial



Mounting Plate



Lever



Rivets (2)



Spacer

Other parts required (not included):

ACS A-510-5 ignition switch

30 minutes two part epoxy

Recommended – square head duplicate key

Assembly:

The key's head should be cut so that the overall length of the key is between 29 and 30mm.

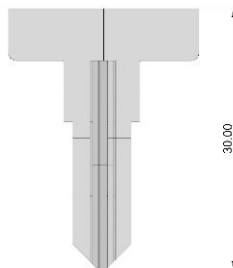

Figure 1

The key should insert solidly into the lever.



Figure 2

Assemble the mounting plate assembly by applying a small amount of epoxy between the dial and mounting plate. Insert the rivets and tap them in with light hammer blows. Ensure that the ignition switch alignment key is in the correct position.

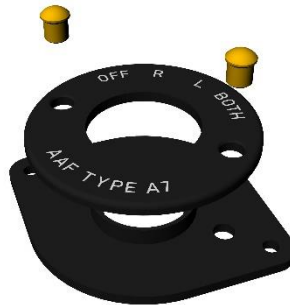

Figure 4

Mount the ignition switch to the plate so that the top retaining nut is flush with the top.



Figure 5

Add the spacer.



Figure 6

With the key inserted, test fit the lever to verify height and alignment.



Figure 7

Using quality 30 minute epoxy, add until the key slot is half full.



*Figure 8*

With the knob in the upside down position, lower the ignition onto the knob, taking care to align the lever's index mark to the OFF / L / R / BOTH side of the plate.

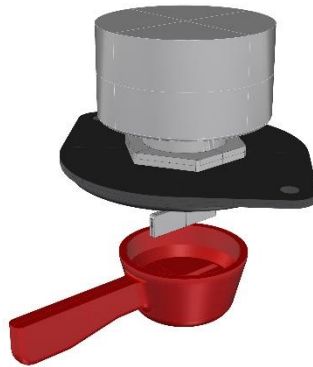

*Figure 9*

Keep the entire assembly inverted and vertical until the epoxy is fully cured. The key can now be removed and the spacer is discarded.



*Final Assembly*